

1<sup>st</sup> Reading  
2-13-18  
2<sup>nd</sup> 3-13-18  
3<sup>rd</sup> 4-10-18

ORDINANCE NO. 178

AN ORDINANCE APPROVING THE GARFIELD PLANNING AREA

WHEREAS, Arkansas' municipal planning statutes require planning commissions to prepare a planning area map and description, designating the area within the municipality's territorial jurisdiction for which they will make studies and prepare plans, ordinances, and regulations; and

WHEREAS, it is the desire of the City Council that the Garfield planning area boundary description and map, as recommended by the Garfield Planning Commission, be accepted and formally approved by ordinance.

NOW, THEREFORE, BE IT ORDAINED BY THE CITY COUNCIL OF THE CITY OF GARFIELD, ARKANSAS:

SECTION 1. That the Garfield Planning Area Map, which is attached hereto and made a part hereof, and the description thereof, which follows; both of which have been approved by the Garfield Planning Commission, be and are hereby approved:

ALL OF THE FOLLOWING DESCRIBED AREA:

ALL OF SECTIONS 8, 17, 20, 28, 29, 31, 32, 33, 34, OF T 21N, R 28W; ALL OF S 36, T21N, R 29W; ALL OF S 4, T 20N, R 28W; THE WESTERN ¼ OF SECTIONS 9, 16 AND 21, T 21N, R 28W; THE WESTERN ¼, THE SE ¼ OF THE SW ¼, AND THE SW ¼ OF THE SE ¼ OF S 27, T 21N, R 28W; THE SOUTH ½ OF THE WESTERN ¼ OF S 35, T 21N, R 28W; THE NW ¼ OF THE NW ¼ OF S 2, T 20N, R 28W; ALL OF S 3, T 20N, R 28W, LESS AND EXCEPT THE SOUTH ½ OF THE SE ¼; ALL OF S 5, T 20N, R 28W, LESS AND EXCEPT THE SOUTH ½ OF THE SW ¼; ALL OF S 6, T 20N, R 28W, LESS AND EXCEPT THE SOUTHERN ¼; ALL OF S 1, T 20N, R 29W, LESS AND EXCEPT THE SOUTHERN ¼ AND THE NW ¼ OF THE SW ¼; THE EASTERN ¾ OF THE SOUTH ¼ AND THE NE ¼ OF THE SE ¼ ALL IN S 25, T 21N, R29W; THE SOUTHERN ¾ OF S 30, T 21N, R 28W, LESS AND EXCEPT THE SW ¼ OF THE NW ¼, THE E ½ OF THE SE ¼ OF S 35 T21N R 29W, ALL BEING IN BENTON COUNTY, ARKANSAS.

SECTION 2. That all ordinances and parts of ordinances in conflict herewith be and are hereby repealed.

SECTION 3. That a duly certified copy of this ordinance shall be forwarded to the Towns of Avoca and Gateway, the City of Pea Ridge, and the Benton County Planning Office, and shall be filed of record in the Benton County Circuit Clerk's Office.

PASSED AND APPROVED THIS 10<sup>th</sup> DAY OF April, 2018.

Attest:

*Teresa D. Vining*  
Recorder-Treasurer

TERESA D. VINING  
Notary Public-Arkansas  
Benton County  
My Commission Expires 05-12-2025  
Commission # 12693938

*Corey Bladner*  
Mayor

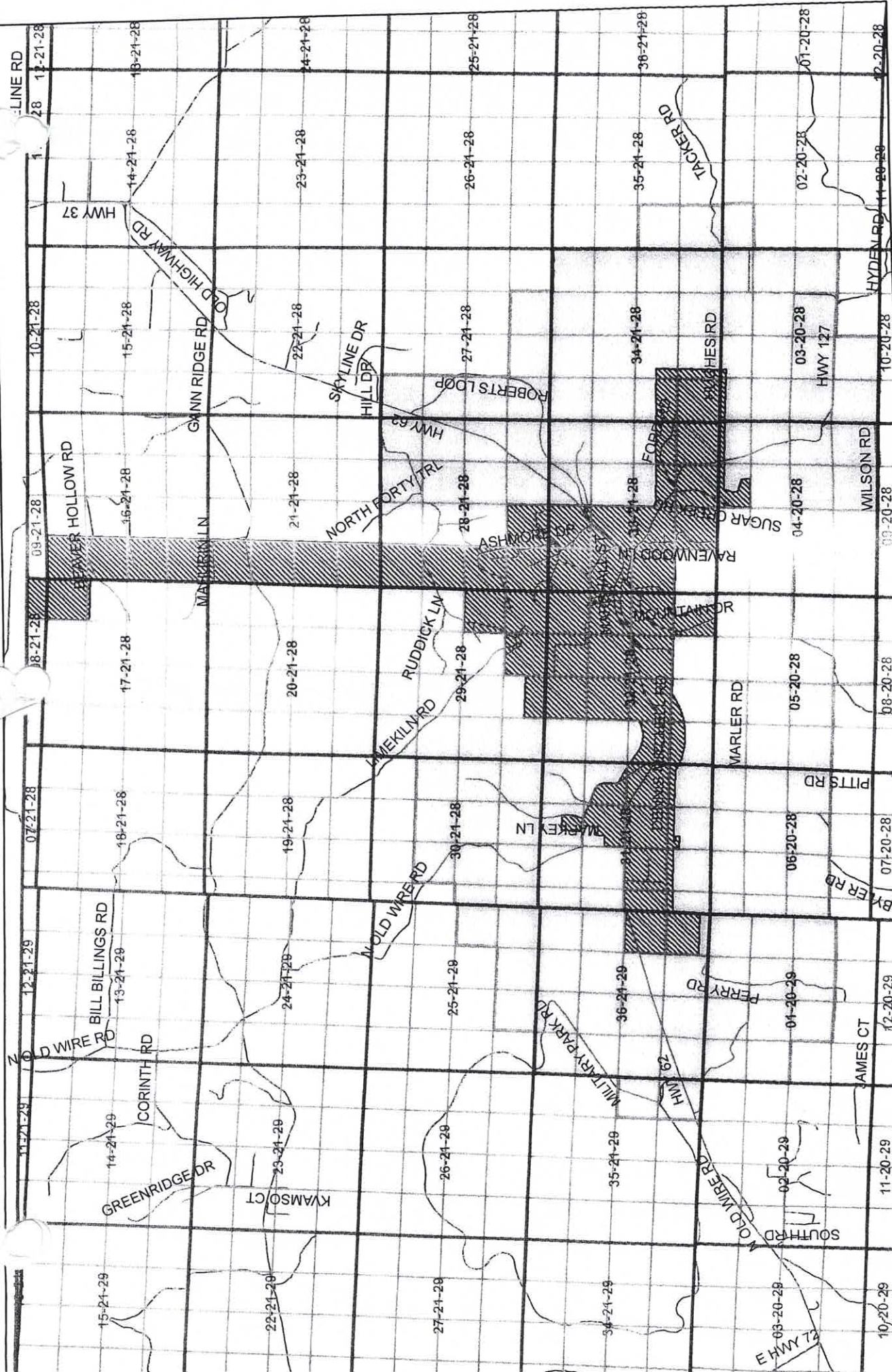

**Map Features**

- Roads
- Section
- Quarter Quarter
- Garfield Planning Area
- Garfield City Limits

Date: \_\_\_\_\_

Title: \_\_\_\_\_

Mayer: \_\_\_\_\_

Recorder/Treasurer: \_\_\_\_\_

Planning Commission Chairman: \_\_\_\_\_

Scale: 0 0.25 0.5 1 Miles

# Garfield Planning Area Boundary

## Official Map-2018



Disclaimer: This map was developed from the best available sources and constitutes a graphic representation of these data sources. No guarantee of accuracy is granted, nor is any responsibility for reliance thereon assumed. In no event shall the NWA/PC or any other entity be liable for direct, indirect, incidental, consequential or special damages of any kind, including, but not limited to, loss of anticipated profits or benefits arising out of use of or reliance on the data. The NWA/PC and/or any other entity are in no way responsible or liable for any misrepresentation or re-use of this map. Distribution of this map is intended for information purposes only and should not be considered authoritative for engineering, legal and other site-specific uses.